

ITEM	PART NO	DESCRIPTION	MATERIAL	PLATING
①	SBY5.9AA-B	BARREL	BS	Au
②	SBY5.9AA-P	PLUNGER A	SK-4	PdCo
③	SBY5.9AA-PB	PLUNGER B	BeCu	HARDENING Au
④	SBY5.9AA-S	SPRING	SWP	Au
MARK	DESCRIPTION OF REVISION		DATE	NAME

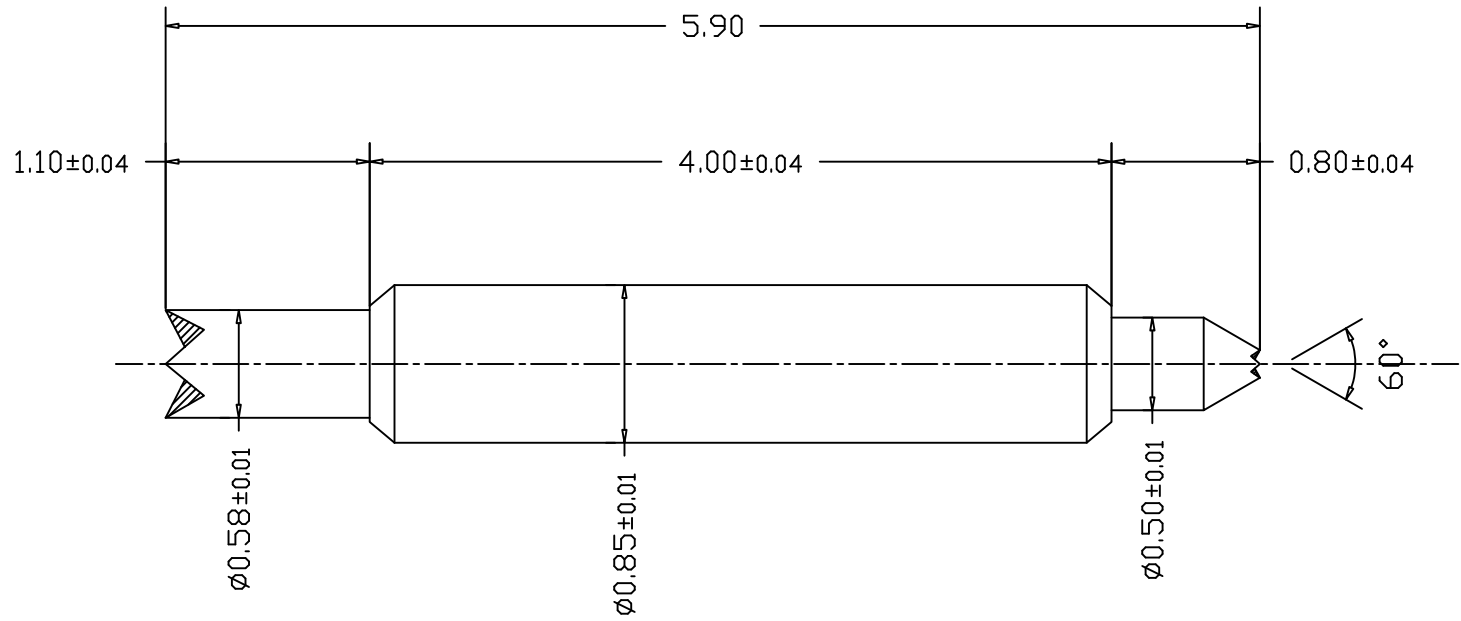

(Note)

- 1. Max Stroke 1.1 mm.
- 2. Recommended Contact force : 35gf at 1.0 mm. stroke

DESIGNED	TITLE		
CHECKED	ASSEMBLY DRAWING		
APPROVED	SIZE	DWG NO.	△
S.Izumi	A4	SBY5.9AA	
DRAWN	SCALE	Link-MicRo' Co.,Ltd..	
2006.04.04			