

| ITEM | PART NO | DESCRIPTION | MATERIAL | PLATING | |
|------|-------------------------|-------------|----------|--------------|------|
| ① | LFV3.1AA-B | BARREL | PBT | Au | |
| ② | LFV3.1AA-PA | PLUNGER A | SK-4 | Silvaco | |
| ③ | LFV3.1AA-PB | PLUNGER B | BeCu | HARDENING Au | |
| ④ | LFV3.1AAH-SP | SPRING | SWP H/T | HARDENING Au | |
| | | | | | |
| MARK | DESCRIPTION OF REVISION | | | DATE | NAME |
| △ | | | | | |

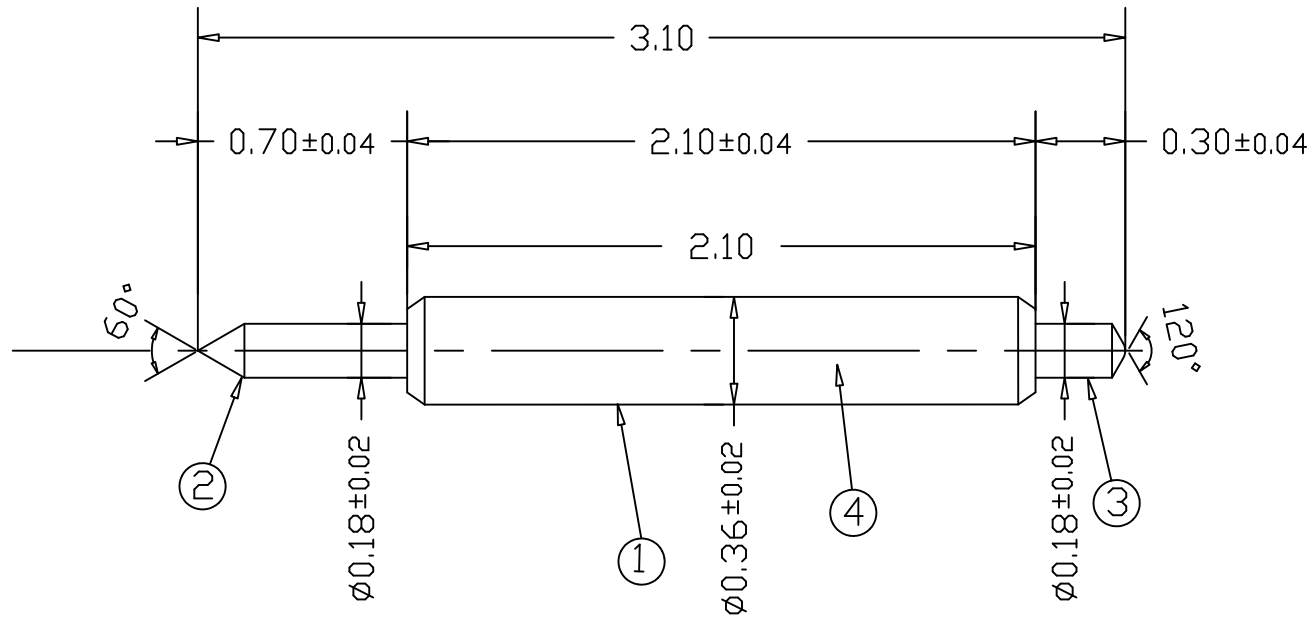

(Note)

- Working Stroke : 0.3mm (Full Stroke : 0.35mm)
- Spring force : 30gf ± 10% @ working stroke

| | | | |
|---------------------|-------------------------------|----------------------|---|
| DESIGNED S.Izumi | TITLE Assembly Drawing | | |
| CHECKED | SIZE A4 | DWG NO. LFV3.1AAH | △ |
| APPROVED S.Izumi | SCALE Link-MicRo' Co.,Ltd. | | |
| DRAWN 2005.11.01 | | | |